

CENTRALT FÖRBINDELSER STOCKHOLM UPPSALA ARLANDA STADSGATA GATURUM SAMVARO BALKONGER LOFTGÅNGAR SOLIGT PASSERSYSTEM SÄKERHET BERGVÄRME SKOG IDROTTSHALLAR FRILUFTSLIV

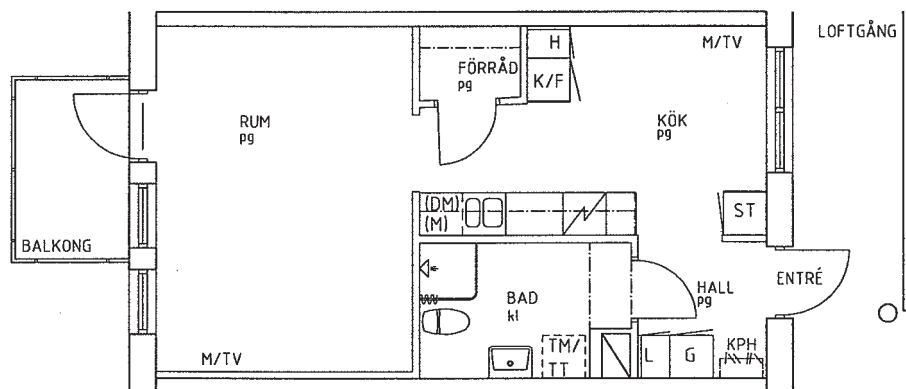







1 rum och kök - 42 kvm

2

**Antal lägenheter: 7**

|                             |                             |
|-----------------------------|-----------------------------|
| Hus 1                       | Hus 2                       |
| LGH 502:101 plan 1          | LGH 502:211 plan 2          |
| LGH 502:111 plan 2          | LGH 502:212 plan 2          |
| LGH 502:112 plan 2          | LGH 502:221 plan 3          |
|                             | LGH 502:222 plan 3          |
| Inflyttning 1 november 2010 | Inflyttning 1 december 2010 |
| Prel. hyra 5 904:-/mån      | Prel. hyra 5 904:-/mån      |

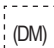
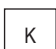
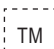
**Förklaringar**

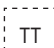
|   |   |                                    |
|---|---|------------------------------------|
|  Garderob/högskap |  Kyl/Frys                   | pg Ekparkett                       |
|  Linneskåp       |  Spis                      | kl Klinkergolv                     |
|  Städskåp        |  Förberett för diskmaskin  | M Multimediauttag för telefon/data |
|  Kyl             |  Förberett för tvättmaskin | TV Uttag för TV                    |
|  Frys            |  Förberett för torktumlare | KPH Kapphylla                      |
|   |   | (M) Förberett för micro            |

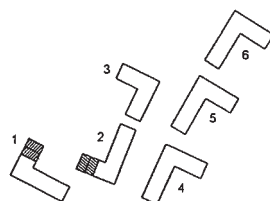
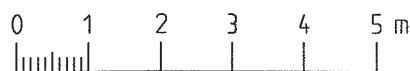

Kontaktuppgifter:

Kerstin Hemlin-Olsson  
Telefon 08-514 935 26

Wahlin fastigheter  
Box 515  
169 29 Solna

k.hemlin-olsson@wahlinfastigheter.se  
www.wahlinfastigheter.se